

PRO1 R THERMO



- 1. ADVANCED PERFORMANCE**
 / WaterPlus technology*: up to 16%** more hot water available
 / Compliant with top ESWH regulations
 / Exchange coil for extra integration

ENERGY CLASS



- 2. FULL COMFORT**
 / External temperature setting
 / Double safety thermostat

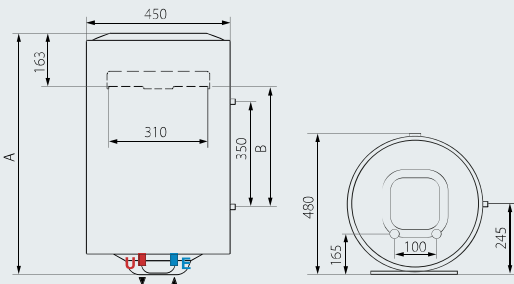
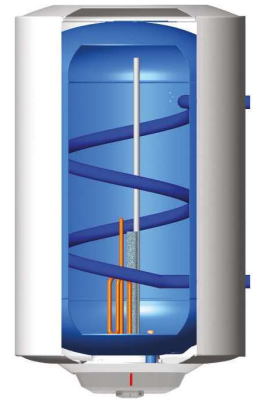

OVERALL DIMENSIONS

1.8 kW		PRO1 R 80 VTD 1,8K	PRO1 R 80 VTS 1,8K	PRO1 R 100 VTD 1,8K	PRO1 R 100 VTS 1,8K	PRO1 R 100 VTD 1,8K PL EU
A	mm	748	748	900	900	900
B	mm	370	370	522	522	522

1.8 kW		PRO1 R 80 VTD 1,8K EU	PRO1 R 80 VTS 1,8K EU	PRO1 R 80 VTD 1,8K PL EU	PRO1 R 100 VTD 1,8K EU	PRO1 R 100 VTS 1,8K EU
A	mm	748	748	748	900	900
B	mm	370	370	370	522	522

NOTE: The Nominal capacity listed in this catalogue identifies the product category. The actual product capacity is listed in the relative technical documentation.

* Patented in Spain, patent pending in IT, FR, TK, RU, CN, VN, UAE

** Maximum estimated saving, depending on models. Comparison made using V40 test results at maximum operating temperature between current ATG products and new ATG products equipped with WaterPlus Technology

LEGEND

- E** Cold water inlet G 1/2"
- U** Hot water outlet G 1/2"

PRO1 R THERMO

1,8 kW - TECHNICAL DATA

		PRO1 R 80 VTD 1,8K	PRO1 R 80 VTS 1,8K	PRO1 R 100 VTD 1,8K	PRO1 R 100 VTS 1,8K
Nominal Capacity	L	80	80	100	100
Installation		V	V	V	V
Coil pipes		Right	Left	Right	Left
Power	KW	1,8	1,8	1,8	1,8
Voltage	V	230	230	230	230
Heating time (T=45 degree celsius)	h,min	2,11	2,11	2,46	2,46
Heat dispersion at 65 degree celsius	KWh/24h	1,51	1,51	1,62	1,62
Max working pressure	bar	8	8	8	8
Max working temperature	°C	75	75	75	75
Weight	kg	23	23	26,5	26,5
IP Class	IP	IPX3	IPX3	IPX3	IPX3

PRO1 ECO	80 VTD	80 VTS	100 VTD	100 VTS
CODE	3201814	3201815	3201816	3201817

1,8 kW - TECHNICAL DATA

		PRO1 R 80 VTD 1,8K EU	PRO1 R 80 VTS 1,8K EU	PRO1 R 100 VTD 1,8K	PRO1 R 100 VTS 1,8K
Nominal Capacity	L	80	80	100	100
Installation		V	V	V	V
Coil pipes		Right	Left	Right	Left
Power	KW	1,8	1,8	1,8	1,8
Voltage	V	230	230	230	230
Heating time (T=45 degree celsius)	h,min	2,11	2,11	2,46	2,46
Heat dispersion at 65 degree celsius	KWh/24h	1,51	1,51	1,62	1,62
Max working pressure	bar	8	8	8	8
Max working temperature	°C	75	75	75	75
Weight PRO1 R VTD 1,8K	kg	23	23	26,5	26,5
Weight PRO1 R VTD 1,8K EU	Kg	21,5	21,5	21,5	21,5
IP Class	IP	IPX3	IPX3	IPX3	IPX3

PRO1 ECO	80 VTD	80 VTS	100 VTD	100 VTS
 Energy class	C	C	C	C
Tapping profile	M	M	L	L
CODE	3201913	3201914	3201915	3201916
CODE With Plug and Cable	3201908		3201909	

NOTE: The Nominal capacity listed in this catalogue identifies the product category.
The actual product capacity is listed in the relative technical documentation.