

# PRO1 R NEW



WATER PLUS



EXTERNAL TEMPERATURE REGULATION



DOUBLE SAFETY THERMOSTAT



TITAN SHIELD



HIGH EFFICIENCY INSULATION



ITALIAN DESIGN



## 1. ADVANCED PERFORMANCE

- / WaterPlus technology\*: up to 16%\*\* more hot water available
- / Compliant with top ESWH regulations

## 2. FULL COMFORT

- / External temperature setting
- / Double safety thermostat

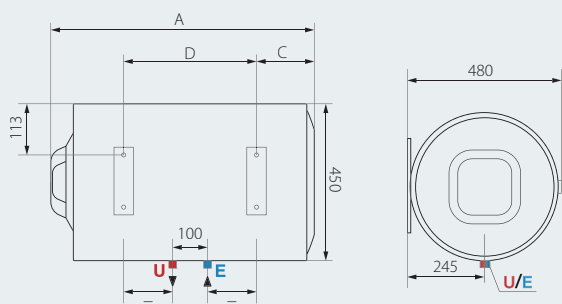
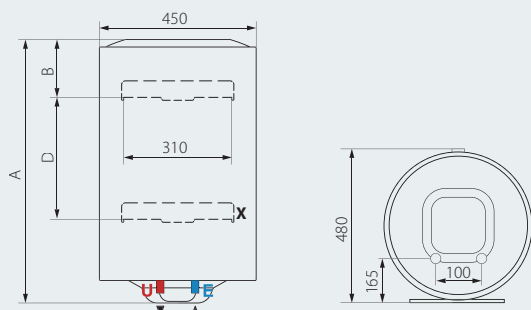

## OVERALL DIMENSIONS

1.5 kW		PRO1 R 50 V	PRO1 R 80 V	PRO1 R 100 V	PRO1 R 50 H	PRO1 R 80 H	PRO1 R 100 H
A	mm	543	748	900	543	748	900
B	mm	163	163	163	-	-	-
C	mm	-	-	-	163	178	178
D	mm	-	-	-	159	334	486

1.8 kW		PRO1 R 50 V 1,8K PL	PRO1 R 80 V 1,8K PL	PRO1 R 100 V 1,8K PL	PRO1 R 65 V 1,8K PL EU	PRO1 R 80 H 1,8K PL EU	PRO1 R 100 H 1,8K PL EU	PRO1 R 120 V 1,8K PL	PRO1 R 150 V 1,8K PL
A	mm	543	748	900	665	748	900	1108	1283
B	mm	163	163	163	163	-	-	166	164
C	mm	-	-	-	-	178	178	-	-
D	mm	-	-	-	-	334	486	-	944

2 kW		PRO1 R 50 V 2K	PRO1 R 80 V 2K	PRO1 R 100 V 2K	PRO1 R 80 H 2K
A	mm	543	748	900	748
B	mm	163	163	163	-
C	mm	-	-	-	178
D	mm	-	-	-	334

3 kW		PRO1 R 80 H 3K EU	PRO1 R 100 H 3K EU
A	mm	748	900
C	mm	178	178
D	mm	334	486

The capacity indicated in this catalogue identifies the product category.  
The effective capacity of the product is given in the relevant technical documentation provided with the product.

\* Patented in Spain, patent pending in IT, FR, TK, RU, CN, VN, UAE  
\*\* Maximum estimated saving, depending on models. Comparison made using V40 test results at maximum operating temperature between current ATG products and new ATG products equipped with WaterPlus Technology

LEGEND  
**E** Cold water inlet G 1/2"  
**U** Hot water outlet G 1/2"  
**X** Additional bottom fixing bracket only for 150 Lt model